

Warmer

Part No. 42945
Revised June 1996

Instruction Manual Model #5598





 **GOLD MEDAL**®

FUNFOOD EQUIPMENT & SUPPLIES

Cincinnati, OH 45241-4807 USA

SAFETY PRECAUTIONS

	⚠ CAUTION
	This equipment is designed and sold for commercial use only. This equipment is not to be used by the consumer in home use. Do not allow direct contact of this equipment by the public when used in food service locations. Only personnel trained and experienced in the equipment operation may operate this equipment. Carefully read all installation instructions before operating the equipment.

	⚠ WARNING
	Always wear safety glasses when servicing this equipment.

	⚠ WARNING
	NEVER put your fingers or any object into the heating area. We do NOT assume any liability for injury due to careless handling or operation of this equipment.

	⚠ WARNING
	Any alterations to this equipment will void the warranty and may cause a dangerous situation. NEVER make alterations to the equipment.

	⚠ DANGER
	Machine must be properly grounded to prevent electrical shock to personnel. Do NOT immerse the equipment in water. Always unplug the equipment before cleaning or servicing.

NOTE

The information, specifications and illustrations contained in this manual represent the latest data available at time of publication. Right is reserved to make changes as required at the discretion of Gold Medal Products Company without notice.

GENERAL DESCRIPTION

This manual provides instructions for operating, cleaning, and maintaining the Gold Medal Products, Model 5598 Warmer.

This Warmer is produced using high quality components and will provide years of trouble-free operation when properly operated and maintained. Please read this Manual before operating your Warmer.

This Warmer is designed to hold product from a precooked condition, such as hot dogs on a removable stationary display rack. The display area is lighted and temperature controlled. The display area temperature is shown by a L.C.D. (Liquid Crystal Display) located on the front control panel. A tempered glass door and panels provides easy access and viewing of product in the display area.

SPECIFICATIONS

CAPACITY

Hot Dog Rack—can hold a maximum of 24 packaged hot dogs

ELECTRICAL

120 VAC, 60 Hz. 7 Amps. 6 foot (1.83 meters) grounded power cord.

DIMENSIONS

18" Wide x 18" Deep x 30 ½" High.

OPTIONAL

Stationary Flat Rack, Gold Medal Products part number 5577 can be ordered for this unit for other products such as nacho, portion pack cheese, etc.

INSTALLATION

UNPACKING

Check the contents and all wrappings when unpacking your unit. Inspect all parts for damage, that may have occurred during shipping. Report any damages or shortages to the carrier.

NOTE: Save all packing materials if filing a damage claim.

SETUP

1. Position the Warmer upright on the counter.
2. Remove rack and clean as described in the CLEANING section.
3. Clean the glass door, panels and metal surfaces of the cabinet as described in the CLEANING section.
4. Make sure power switch is in the OFF position, then plug the power cord into a 120 volt, 15 amp receptacle, ground according to Local Code.
5. The Warmer is now ready for operation.

MACHINE OPERATION

The Warmer is factory set for holding precooked packaged hot dogs. Temperature control is adjustable and can be adjusted to hold a maximum cabinet temperature of approximately 180° F.

NOTE: The temperature control offers settings from 1 to 9. We recommend this control be set to local codes when holding product such as hot dogs, pizza or any kind of volatile product.

THE CONTROL PANEL

POWER SWITCH

For applying power to warmer.

TEMPERATURE CONTROL

Allows adjustment to display area temperature.

TEMPERATURE DISPLAY

Displays the display area temperature.

OPERATING INSTRUCTIONS

Press the power switch ON. The display lights will come on. The display area temperature will stabilize in approximately 20 minutes.

CLEANING

A regular cleaning routine will enable you to maintain a clean and attractive display. The frequency of cleaning will vary depending on use and other conditions in your specific application. **NOTE:** Do not use abrasive cleanser, scouring pads, steel wool, or other cleaning tools that can scratch the metal surfaces or the glass in the unit.

	<p style="text-align: center;">▲ WARNING</p> <p>Never attempt to clean components while they are hot. Severe burns can result. Particular care should be taken around the vent holes located in the cabinet ceiling.</p>
---	---

DISPLAY AREA and CABINET CLEANING

1. Make sure the power switch is in the "OFF" position.
2. Unplug power cord from the receptacle.
3. Allow unit to cool until all parts are cool to the touch.
4. To remove the display rack for cleaning. Simply open cabinet door and lift rack out.
5. Wash the display rack with hot, soapy water. **NOTE:** Do not use metallic scrapers or other utensils that can scratch or mar the finish of these components. Soak these components in hot soapy water, if necessary, to loosen any baked-on deposits.
6. Following the sanitizing procedures for your area, sanitize: the display rack, and allow to dry.
7. Clean the glass door and all glass, and metal surfaces of the cabinet, inside and outside. Use a non-toxic cleaner, and dry all surfaces with a soft cloth to avoid scratching.

MAINTENANCE INSTRUCTIONS

	⚠ CAUTION
	<p>THE FOLLOWING SECTIONS OF THIS MANUAL ARE INTENDED ONLY FOR QUALIFIED SERVICE PERSONNEL WHO ARE FAMILIAR WITH ELECTRICAL EQUIPMENT. THESE ARE NOT INTENDED FOR THE OPERATOR.</p>

	⚠ WARNING
	<p>Adequate eye protection must be used when servicing this equipment to prevent the possibility of injury.</p>

	⚠ DANGER
	<p>Do NOT immerse the equipment in water. Unplug your machine before servicing.</p>

ORDERING SPARE PARTS

1. Identify the desired part by checking it against the photos, illustrations, and/or the parts list.
2. When ordering, please include part number, part name, and quantity desired.
3. Please include your model name and machine serial number (located on the machine nameplate) with your order.
4. Address all parts orders to:

Parts Department
Gold Medal Products Co.
10700 Medallion Drive
Cincinnati, Ohio 45241-4807

or, place orders at:

(513) 769-7676
Fax: (513) 769-8500
E-mail: goldme19@eos.net

CABINET ASSEMBLY – EXPLODED VIEW

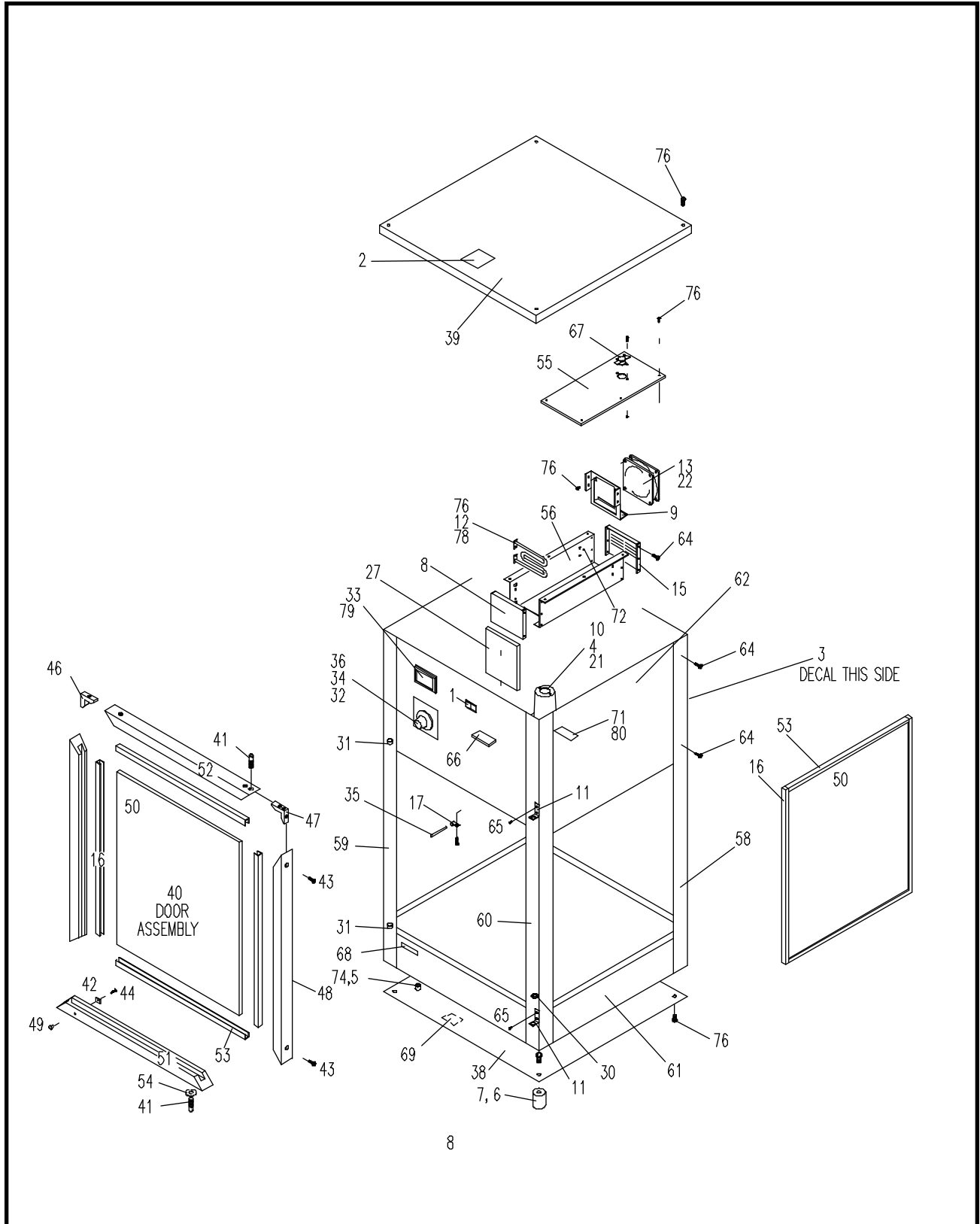

PARTS LIST

Item No.	Part No.	Description
1	12115	Rocker Switch
2	12173	Warning, Quad-lingual
3	42946	Decal, Fresh -N- Hot
4	42947	Reflector Flood Light Coated
5	22038	Lead-in Cord, 15 Amp Plug
6	40488	Foot
7	40489	Rubber Tip
8	40516	End Cap
9	40519	Bracket, Fan Mount
10	40589	Light Shield
11	42978	Door, Mounting Bracket
12	40710	Element Tubular
13	40721	Axial Fan
14	n/a	
15	40727	End Cap, Louvered
16	40730	Rigid Channel 19 ½"
17	40731	Cord Clamp
18	40737	Black Wire, See Wiring Diagram
19	40739	White Wire, See Wiring Diagram
20	40742	Black Wire, See Wiring Diagram
21	40743	Lamp Holder Assembly
22	40744	Plug And Cord Assembly
23	40754	White Wire, See Wiring Diagram
24	40755	White Wire, See Wiring Diagram
25	40756	White Wire, See Wiring Diagram
26	40757	Black Wire, See Wiring Diagram
27	40761	Insulation
28	n/a	
29	n/a	
30	40768	Nylon Washer, Cabinet Door
31	40782	Bushing
32	40790	Controls
33	40792	Temperature Display
34	40793	Knob, Controls
35	40794	Probe, Stl. St.
36	40799	Scale Plate, Temperature
37	n/a	
38	42703	Bottom Cover
39	42704	Dome Cover
40	42724	Door Assembly

PARTS LIST (continued)

Item No.	Part No.	Description
41	40548	Hinge Pin, Door
42	40704	Block, Magnet
43	40717	10-32 x 12" Ph. Fl. Hd. Ms.
44	40718	8-32 x 1" Ph. Fl. Hd. Stl. St.
45	n/a	
46	40783	Door Angle
47	40784	Door Angle, Hinge Side
48	40787	Door Frame, Side
49	41013	Knob, Door
50	42725	Glass, Front and Side
51	42727	Door Frame, Bottom
52	42728	Door Frame, Top
53	42866	Channel, 13 ¹⁵ / ₁₆ "
54	87261	¼" Washer
55	42733	Cover Heat Chamber
56	42738	Heat Chamber Assembly
57	47436	Thermometer Cabinet
58	42711	Front Corner Post
59	42713	Left Rear Corner Post
60	42715	Right Rear Corner Post
61	42734	Base Pan Weldment
62	42736	Dome Weldment
63	n/a	
64	42937	12-14 x ³ / ₈ " Type-B SMS
65	42938	12-14 x ³ / ₈ " Type-B SMS
66	47208	Terminal Block
67	47385	Thermostat Warmer
68	47561	Magnetic Catch
69	74119	Warning, Disconnect Power
70	74144	10-32 x ¼" Rd. Hd. Ph.
71	74795	Warning, Max Lamp 50 Watts
72	75328	⁵ / ₁₆ " Bushing
73	n/a	
74	87194	Strain Relief
75	n/a	
76	87314	8-32 x ¼" Ph Pan M/S
77	n/a	
78	89129	8-32 Stl. St. Hex Nut
79	40735	Spacer, Display
80	42948	Coated Bulb Label

WARRANTY

WE WARRANT to the original purchaser the Gold Medal equipment sold by us to be free from defects in material or workmanship under normal use and service. Our obligation under this warranty shall be limited to the repair or replacement of any defective part for a period of six (6) months from the date of sale to the Original Purchaser with regard to labor and two (2) years with regard to parts and does not cover damage to the equipment caused by accident, alteration, improper use, voltage, abuse, or failure to follow instructions.

THIS WARRANTY IS IN LIEU OF ALL OTHER WARRANTIES EXPRESSED OR IMPLIED, AND OF ALL OTHER OBLIGATIONS OR LIABILITIES ON OUR PART, INCLUDING THE IMPLIED WARRANTY OF MERCHANTABILITY. THERE ARE NO WARRANTIES WHICH EXTEND BEYOND THE DESCRIPTION ON THE FACE HEREOF. We neither assume, nor authorize any other person to assume for us, any other obligation or liability in connection with the sale of said GOLD MEDAL equipment or any part thereof.

The term "Original Purchaser" as used in this warranty shall be deemed to mean that person, firm, association, or corporation who was billed by the GOLD MEDAL PRODUCTS COMPANY, or their authorized distributor for the equipment.

THIS WARRANTY HAS NO EFFECT AND IS VOID UNLESS THE ORIGINAL PURCHASER FIRST CALLS GOLD MEDAL PRODUCTS COMPANY AT 1-800-428-2676 TO DISCUSS WITH OUR SERVICE REPRESENTATIVE THE EQUIPMENT PROBLEM, AND, IF NECESSARY, FOR INSTRUCTIONS CONCERNING THE REPAIR OR REPLACEMENT OF PARTS.

NOTE: This equipment is manufactured and sold for commercial use only.



GOLD MEDAL PRODUCTS COMPANY
10700 Medallion Drive
Cincinnati, Ohio 45241-4807 USA